

# Air-Seeding Equipment

Air Carts, Disc Drills, Hoe Drills, and Openers



JOHN DEERE





# KEEP TECHNOLOGY SIMPLE

**Simple. Concise. Innovative.** We redesigned our C-Series Air Carts from the ground up keeping your technology needs in mind. Seed up to eight times more precisely<sup>1</sup> with new AccuRate™ stainless steel electric meters, letting you change speed and volume of product at each meter on the G5<sup>Plus</sup> display. Plus, the industry exclusive EZCal™ system will save you steps and time by sending those calibration numbers automatically to the cab display while the integrated tank scales do the weighing for you. So go ahead. Keep your cab clutter-free and track all your technology and data on the only display you need.

<sup>1</sup> Based on seeding with an 8 primary run air cart and a 24 m (80 ft.) air seeder. Prescription zones would improve from 24 m (80 ft.) zones to 3 m (10 ft.) zones.







## CONTENTS

Introduction .....2-3

### Air Carts

Leading Air Carts..... 4-5

- AccuRate™ Stainless Steel Electric Meters
- High Fidelity Prescriptions

Leading Air Carts..... 6-7

- SectionCommand™ Pro
- Curve Compensation
- 50-Bushel Mini-Tank
- Blower Packages

Trailing Air Carts.....8-9

- EZCal™

Trailing Air Carts..... 10-11

- Tank Scales and ActiveCal™
- Low Profile Hopper
- Wireless Controlled Hydraulic Conveyance System

### Air Drills

N500C No-Till Air Drills ..... 12-13

- AutoTrac Implement Guidance

N500 No-Till Air Drills ..... 14-15

N500F No-Till Air Drills ..... 16-17

- RelativeFlow™ Blockage

P600 and P500 Precision Air Hoe Drills .....18-19

- TruSet™ Technology

H500 and H500F Air Hoe Drills..... 20-21

### Openers

ProSeries™ Opener .....22

P600 and P500 Precision Air Hoe Drill Openers .....23

Precision Upgrades ..... 24-25

Parts, Attachments & Service..... 26-27

Precision Agriculture ..... 28-29

Specifications ..... 30-31

Dealer Service .....32



# SIZE UP YOUR ACCURACY



## ***HIGH FIDELITY PRESCRIPTIONS***

Enjoy a significant improvement in on-farm management precision, achieving up to eight times greater accuracy compared to previous air seeders by adjusting the speed and volume of product application at each meter with high fidelity prescriptions.<sup>1</sup>

<sup>1</sup>Based on seeding with an 8 primary run air cart and a metric air seeder. Prescription zones would improve from metric zones to metric zones.

*Available on trailing and leading carts.*



**Seed smart with accuracy you can measure.** With the new air carts from John Deere, you can control seed and fertiliser placement from the comfort of the cab with individually controlled AccuRate™ stainless steel electric meters. Offering total leading tank capacities from 12,333 L to 22,905 L, you'll be able to seed more hectares between fills with the new tank split offerings. With features such as EZCal™, ActiveCal™, High-Fidelity Prescriptions, Curve Compensation, SectionCommand™ Pro and Blower Automation, you'll have confidence knowing product is being accurately distributed. Plus, using a leading air cart sets up a great foundation for uniform emergence by minimising soil compaction from the cart's tyres.



#### John Deere Leading Air Carts

MODEL	CAPACITY	TANK SPLIT
C350L	12,333 L	5,638/6,695 L
C400L	14,095 L	1,761/5,638/6,695 L
C500L	17,619 L	6,695/3,171/7,752 L
C550L	19,381 L	1,761/6,695/3,171/7,752 L
C650L*	22,905 L	1,761/9,162/4,581/7,400 L

\*Not available in New Zealand

## AccuRate™

### STAINLESS STEEL ELECTRIC METERS

Keep maintenance and repair costs down with the new corrosion-resistant AccuRate stainless steel electric meters.

*Available on trailing and leading carts.*



# REDUCE COSTLY OVERLAPS

Reduce costly overlaps that waste product and skips that affect plant population with **SectionCommand™ Pro**. This provides you more consistency when seeding your fields while improving your yield potential.

You can control commodity flow by maintaining the right application rates across each primary thanks to the new **AccuRate™** individual electric meter. Eliminate potential seed damage and dumping effect by stopping the meter when each section is shut off, leading to even crop emergence and uniform crop maturity at harvest.

Say goodbye to overpopulating turn rows with **curve compensation**. This feature adjusts meter rates to the tool speed both on the inside and outside of a turn. The result is rows that are metered more closely, matching the desired product rate across the tool.





## BLOWER PACKAGES

Whatever your operation, our complete John Deere solution will have the blower package you need. With **blower automation**<sup>1</sup>, you can set your blower speed in the cab and the tractor will maintain it dependent on variable effects such as oil temperature or ambient conditions.

Blower packages are available in:

- Single Standard-Capacity
- Single High-Capacity
- Double Standard-Capacity
- Double High-Capacity

<sup>1</sup> Requires a tractor electronic control unit 3 which is available on 30 series and newer John Deere tractors.



## MINI-TANK

Available on C400, C550, C650 and C850 air carts, the 1761 L mini-tank option allows for more flexibility in seeding and fertiliser rates. With multiple fill locations, this option provides easy filling with bags, bulk bags, or the conveyance system.

*Available on trailing and leading carts.*





# LARGE SCALE PERFORMANCE

## FOR SMALL GRAIN SEEDING

**Balance your total system with trailing air carts.** The new trailing carts offer total tank capacities ranging from 12,333 L to 29,953 L. These carts are designed to provide a favourable balance between cart, tractor and drill and require less tractor horsepower to pull the entire system. The individually controlled stainless steel electric meters along with features such as EZCal™, ActiveCal™, integrated tank scales, High-Fidelity Prescriptions, Curve Compensation, SectionCommand™ Pro and Blower Automation allow you to control both seed and fertiliser placement from the cab.



**John Deere Trailing Air Carts**

MODEL	CAPACITY	TANK SPLIT
C350T	12,333 L	5,638/6,695 L
C400T	14,095 L	1,761/5,638/6,695 L
C500T	17,619 L	6,695/3,171/7,752 L
C550T	19,381 L	1,761/6,695/3,171/7,752 L
C650T*	22,905 L	1,761/9,162/4,581/7,400 L
C850T*	29,953 L	1,761/9,162/4,581/14,448 L

\*Not available in New Zealand





## EZCal™

Save steps and time without climbing stairs and crawling under the cart with a new industry exclusive method of calibrating. With a push of the button on the side of the cart EZCal automatically calculates and sends the minimum displacement value (MDV) to the cab eliminating user error. This lets you calibrate 75% faster<sup>1</sup> than previous models and 45% faster<sup>2</sup> than the leading competitor's calibration times.

<sup>1</sup>. Based off internal testing of a current production bag calibration on a 1910 air cart taking 10 minutes to calibrate compared to a EZCal-equipped air cart taking 2 minutes and 15 seconds.

<sup>2</sup>. Based off internal testing of a Bourgault air cart calibration taking 4 minutes compared to a EZCal-equipped air cart taking 2 minutes and 15 seconds.

*Available on trailing and leading carts.*



# TOTAL CONTROL



Control the conveyance arm movement and elevation effortlessly with an easy-to-operate wireless remote. With less physical strain on the operator, and fewer operators needed to move it, you can now fill your tanks without breaking a sweat.

*Available on trailing and leading carts.*



## TANK SCALES WITH ACTIVECAL™

Now you can recalibrate while seeding anytime from the cab with ActiveCal to verify accurate calibration numbers for changing field conditions. You can easily calculate the number of hectares left in each tank with new scales positioned under each tank. With the new G5e cart side display, you'll be able to view tank scale data and pressure as you fill product while also eliminating the need to walk back and forth from cab to cart when calibrating. When you're in the cab, you can use ActiveCal to verify accurate calibration numbers for those changing field conditions.







**New Low Profile  
Hopper for C550 and  
smaller carts**

With twice the fill area as previous hoppers, you'll be able to fill wheat 75% faster than previous models. Plus with the improved manoeuvrability, you'll be able to leave the hopper in one position when filling all tanks.



# FULL **SEED** AHEAD

**The N500C Air Drill delivers.** When time's short and you've got plenty of ground to cover, give the command with full confidence.

With tanks up to 4,228 L capacity, you'll have easy access to the meters. You can seed at widths from 9.1 to 12.8 m (30 to 42 ft.).

Benefit from all the latest John Deere seeding technologies. Accurate in-cab adjustments. Fast, easy calibration. Greater seeding efficiency at headlands and waterways. Accurate population control around contours. Plus, precise seed placement by our ProSeries™ Openers.

Plus, the premium lighting package enhances your visibility. We've added one light in the tank to make filling and cleaning easier and attached two lights to the tank for easier maintenance, blockage checks and overall visibility.







## **AutoTrac™** **IMPLEMENT** **GUIDANCE\***

Precisely place seed and fertiliser no matter the terrain. AutoTrac Implement Guidance steers the tractor to ensure the seeder is on the correct path.

*\*Only available on air drills paired with trailing air carts.*





N500 NO-TILL AIR DRILLS

# GETS YOU IN THE *FIELD* SOONER





## N500 No-Till Air Drills

The N500 No-Till Air Drill is an efficient seeding tool featuring our ProSeries™ opener made to be a workhorse in tough no-till conditions. Available in six different widths to help you get more done: 9.1 m, 11 m, 12.5 m, 12.8 m, 15.2 m, 18.3 m (30, 36, 40, 42, 50 and 60 ft.).

Whether you prefer the productive 12.8 m (42 ft.) or need the increased width of the 18.3 m (60 ft.), all N500 Air Drills are designed for heavy residue, but don't think that's the only use. 5 cm of float in the opener system lets openers follow ground contours without extra down-pressure. When combined with the exclusive active hydraulic down-pressure, you'll get accurate depth control and all-till capability.





**SEED AND  
FERTILISE**

**UP  
TO**

**60**<sup>FT</sup>  
W I D E





# N500F No-Till Air Drill

To win big in small grains, it takes a seeding solution that superseeds your expectations. Choose from four widths in all ranging from 9.1 m (30 ft.) up to 18.3 m (60 ft.).

Get better flotation and reduced soil compaction from the larger mainframe and wing tyres for more uniform seed depth and seed-to-soil contact. And when fields are hilly, the frame sections flex to follow the contour of the ground.

The N500F No-Till Air Drill includes Separate Fertiliser Placement to save you the time, labour, fuel, and cost of a separate fertiliser pass.



## RelativeFlow™ BLOCKAGE SOFTWARE

View flow rate of both the seed and fertiliser on a row by row basis from the inside of your cab with our RelativeFlow Blockage. This exclusive technology, available on all John Deere tools, helps identify any problems before the potential blockage occurs.



# SEED SMART. SEED PRECISELY.

## P600 Precision Air Hoe Drills

Maximise your crop potential across all soil types and field conditions with our lineup of P600 Precision Air Hoe Drills. Monitor row-to-row seeding rates with RelativeFlow™ blockage monitoring. The improved tyre options provide you with better flotation through the field. TruSet™ technology lets you adjust the opener, wing and hitch downforce from the cab and on-the-go. With spacing ranging from 12.2 m (40 ft.) to 27.4 m (90 ft.), the dual knife openers provide uniform seed and fertiliser placement with a consistent spread of 1.9 cm (0.75 in.) vertically and 3.8 cm (1.5 in.) horizontally.



### TruSet™ TECHNOLOGY

Adjust Opener downforce pressure all from the comfort of the cab with TruSet technology. Available\* only from John Deere, jobs that previously took several minutes can now be done in just seconds. You can adapt to changing field conditions on the go and promote greater seed-to-soil contact for improved germination and more consistent emergence.



\*TruSet is only available on the N500C, N500, N500F, and P600.



## P500 Precision Air Hoe Drills

The P500 Precision Air Hoe Drill features an exclusive opener for hydraulic precision depth control that senses and adapts to changing terrain and field conditions. Fertiliser shanks and seed boots maintain consistent depth for accurate seed and fertiliser placement row after row, pass after pass, hectare after hectare. The result is uniform emergence across the field with opportunities for higher yields.

Applying fertiliser while seeding? The P500 uses two independent hydraulic accumulators that let you set packing pressure and fertiliser trip force individually. This design eliminates the need for continuous flow from the tractor, reducing heat build-up in the hydraulic oil and the potential for lost horsepower, all while assuring uncompromised depth control and consistent seed and fertiliser spacing. You can even adjust the press-wheel down pressure as needed to match changing field conditions.





# GREAT STANDS

START WITH UNIFORM DEPTH CONTROL

H500 and H500F Air Hoe Drills





Hectare after hectare, year after year, you need a seeding solution that stands up to tough field conditions, while maintaining consistent seed depth in a variety of soils and residue levels. The H500 and H500F Air Hoe Drills help you get the most out of your seed, fertiliser, and machinery investments. Choose from three different widths to fit your operation: 12.2 m, 12.5 m, 15.2 m, 18.6 m. Plus, with RelativeFlow™ blockage software, you'll spot potential problems before they occur.





# SEED MORE HECTARES WITHOUT ALL THE EXTRA MAINTENANCE

## ProSeries™ Opener

When it comes to seeding precision, consistent seed depth and uniform emergence in virtually all field conditions, you can supersede your expectations with ProSeries.

The narrow seed boot fits tighter to the disc which helps keep the soil in place. We've replaced the bolt with a flag pin to keep the boot from moving. This improves accuracy and reduces wear. The redesigned seed tab fits better in the furrow and keeps the seed from bouncing out.

We've also improved the closing wheel to better close the trench to keep more anhydrous in the ground providing a boost to young plants. Ask your John Deere Dealer about ProSeries compatibility with air seeding equipment.

## P600 Precision Air Hoe Drill Opener

### Uniform emergence across varying field conditions

Place seed and fertiliser where you need with P600 Series Precision Air Hoe Drill Openers. The P600 is available with either the standard double knife or new in-line knife opener for consistent and low maintenance seeding. Both openers provide uniform seed and fertiliser placement with a consistent spread of 1.9 cm (0.75 in.) vertically and 3.8 cm (1.5 in.) horizontally - ensuring both seed safety and quick access to the nutrients to improve germination and overall crop potential. Depth adjustments are now also easier with standard Quick Adjust on both double knife and in-line knife openers, reducing changeover time significantly over the previous standard adjustment.





# P500 Precision Air Hoe Drill Opener

## Refined depth control for uniform emergence

The P500 Precision Air Hoe Drill Opener provides excellent depth control in paired-row and single-row settings. Hydraulics keep the openers engaged, even in rocky and rolling or uneven field conditions.















## **STAY UP AND RUNNING WITH YOUR LOCAL DEALER**

The John Deere dealer network is here to serve you. If you need a part, attachment, or service, you can head to a local dealer and use their expertise to find the right solution for your budget. They know the ins and outs of your air seeder and have a clear understanding of your unique needs. You can count on our highly skilled technicians to keep you up and running.



# AFTERMARKET PARTS & UPGRADES



## Pro-Series™ Opener Aftermarket Upgrade

Gain agronomic advantages and extended wear life for your 90 Series Opener with a Pro-Series Opener aftermarket upgrade. Offers five parts: seed boot, press wheel, serrated closing wheel, seed tab, and closing spring. Opener disc also included.

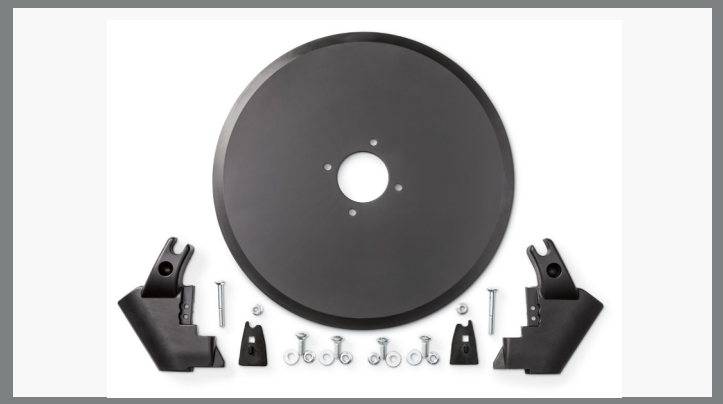

## SFP (Separate Fertiliser Placement) Opener Aftermarket Upgrade

Newly designed sealing plates and scrapers improve the NH<sub>3</sub> sealing capacities of the separate fertiliser placement opener for the 90 Series Opener. Aftermarket upgrade bundle includes scraper, sealing plate, disk opener, and hardware.



## Heavy-Duty Bearings

Better protect your gauge and closing wheels from dirt and debris with new, heavy-duty bearings. Excellent for tough seeding conditions and high speeds.



## Packer Wheel

A newer and wider version of a packer wheel is now available for improved seed-to-soil contact to enhance emergence.



## Spoke Gauge Wheels

An ideal solution for seeding in wet soil conditions, spoke gauge wheels allow mud and debris to flow through the wheel for superior depth performance. Available in standard or narrow widths. Heavy duty options are also available for extended wear life.

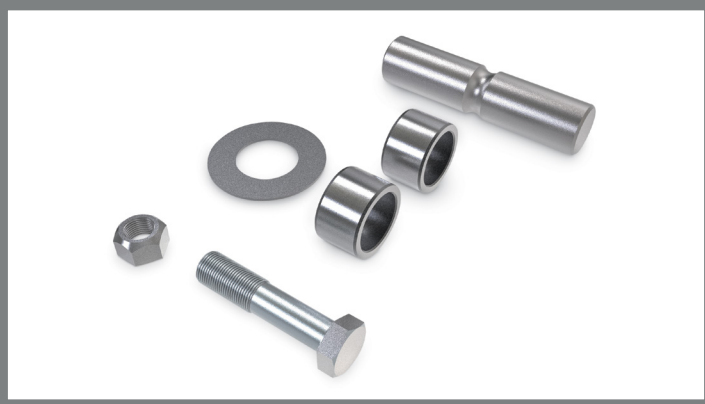

## Main Opener Pivot Pin & Bushing Kit

Containing pin, bushings, and all necessary hardware to service one row, this kit reduces prices compared to individual parts and makes ordering and service simpler to manage.



## Depth Adjust Kit

With a handle, cover, and all necessary hardware for one row, this kit solves issues with wear on the cover and/or handle, offers added strength and durability to Pro-Series and allows 90 Series Opener customers to easily upgrade to Pro-Series components.



# YOUR LINK<sup>™</sup> TO YOUR MACHINES & FIELDS

## JDLink<sup>™</sup> Connected Service

### Connect your machine for free

With JDLink connected service, machine and agronomic data automatically flows to your John Deere Operations Center<sup>™</sup> account, allowing you to remotely support your machines and operators.

Location History lets you view the path travelled by your machine over a 24-hour period for up to 60 days. Monitor location, ground speed, heading, and working or idling status.

## John Deere Operations Centre

### Turn your valuable data into a profitable plan of action

Your seeding data is only useful if you can easily access and share it away from the field. With a free Operations Center account<sup>1</sup>, you can turn your data into insightful actions. And with your permission, you can easily share that data with your trusted partners or advisors.

## Operations Centre Mobile

### View your entire farm from any device

Keep track of your operation anytime, anywhere, with the Operations Center Mobile app. In near real time, you can view planting data, such as seeding speed, varieties, and as-applied and planned seeding rates.

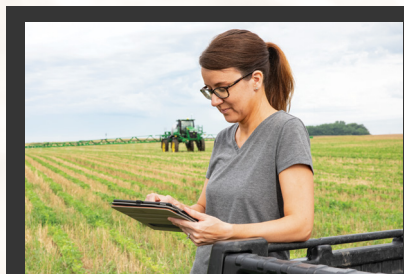

<sup>1</sup> Activation required. JDLink hardware comes standard with the machine. The customer can turn on the JDLink service in their Operations Center account for free. JDLink requires a mobile connection to transfer information from machine to JDLink website. Consult your John Deere Dealer for coverage availability.







## G5 Advanced Package

More automation means more productivity and less stress. That's what you get with the G5 Advanced Package, which bundles five of our most advanced guidance and automation technologies into a single renewable licence. That gives you not only a lower up-front cost, but also technology that gets better over time, as you'll get automatic access to new features as they are released. The G5 Advanced Package includes:

### **AutoPath™**

Save time and make your job easier in complex fields by eliminating guesswork when deciding which guidance line to use.

### **AutoTrac™ Turn Automation**

AutoTrac Turn Automation gives you hands-off and stress-free confidence from one pass to the next. Consistently enter each pass to reduce untilld gaps and rework.

### **AutoTrac™ Implement Guidance**

Precise implement placement cuts out wide-narrow guess rows and keeps spacing accurate.

### **Machine Sync**

On-the-go, stress-free unloading in every condition. Work faster, even with inexperienced chaser bin operators.

### **In-Field Data Sharing**

Between multiple machines and fields, share guidance lines, coverage maps, as-applied pass-to-pass data, and field totals, without wasteful radio chatter.



N500 No-Till Air Drill					
MACHINE CONFIGURATIONS	19.05 cm (7.5 in) Spacing		25.40 cm (10 in) Spacing		
N530 (9.14-m; 30-ft)	48		36		
N536 (10.97-m; 36-ft)	58		44		
N540 (12.19-m; 40-ft)	64		48		
N542 (12.80-m; 42-ft)	68		50		
N550 (15.24-m; 50-ft)	80		60		
N560 (18.29-m; 60-ft)	96		72		

P600 Precision Air Hoe Drill	P640	P660	P670	P680	P690
MACHINE CONFIGURATIONS	12.19 m (40ft) 3-section models	18.28 m (60 ft) 5-section models	21.33 m (70 ft) 5-section models	24.38 m (80 ft) 5-section models	27.43 m (90 ft) 5-section models
Openers system	Independent dual knife design with separate fertiliser placement.				
Standard Features	Carbide-tipped knives maintenance free pivot point and standard residue deflector				
Number of Openers	40-48	60-72	70-84		
Row Spacing	25.4 cm or 30.48 cm (10 or 12 in)	25.4 cm or 30.48 cm (10 or 12 in)	25.4 cm or 30.48 cm (10 or 12 in)	25.4 cm (10 in)	30.48 cm (12 in)
Number of Ranks	3	3	3	3	3
Space between Ranks	127 cm (50 in)	127 cm (50 in)	127 cm (50 in)	127 cm (50 in)	127 cm (50 in)

P500 Precision Air Hoe Drill	P540	P556
MACHINE CONFIGURATIONS	12.19 m (40 ft) 3-section models	17.06 m (56 ft) 5-section models
Openers system	Independent but linked fertiliser shank and seed opener	
Standard Features	Carbide on fertiliser knife and seed opener	
Number of Openers	40	56
Row Spacing	30.48 cm (12 in) (Optional Paired Row)	
Number of Ranks	3	3
Space between Ranks	Minimum of 127 cm (50 in)	

N500F No-Till Air Drill	N530F	N536F	N540F	N543F	N560F
MACHINE CONFIGURATIONS	9.14 m (30 ft)	10.97 m (36 ft)	12.19 m (40 ft)	13.10 m (43 ft)	18.28 m (60 ft)
Seed Spacing	25.40 cm (10 in)	25.40 cm (10 in)	25.40 cm (10 in)	25.40 cm (10 in)	25.40 cm (10 in)
Fertiliser Spacing	50.80 cm (20 in)	50.80 cm (20 in)	50.80 cm (20 in)	50.80 cm (20 in)	50.80 cm (20 in)
Seed openers	36	44	48	52	72
Fertiliser openers	18	22	24	26	36

N500C No-Till Air Drill	N530C	N536C	N540C	N542C
MACHINE CONFIGURATIONS	9.14 m (30 ft)	10.97 m (36 ft)	12.19 m (40 ft)	13 m (42 ft)
Dual Rank Number of Openers				
19.05 cm (7.5 in) Spacing	48	58	64	68
25.40 cm (10 in) Spacing	36	44	48	50
Single Rank Number of Openers				
38.10 cm (15 in) Spacing	24	28	32	34

H500 and H500F Air Hoe Drills	H500 Air-Hoe Drill		H500F Air-Hoe Drill	
MACHINE CONFIGURATIONS	Width	Row Spacing	Width	Row Spacing
3-section models	H541 (12.49 m; 41 ft)	19.05, 25.40, 31.75 cm (7.5, 10, 12.5 in)	H540F (12.19 m; 40 ft)	25.40 cm (10 in)
5-section models	H550 (15.24 m; 50 ft)	19.05, 25.40, 31.75 cm (7.5, 10, 12.5 in)	H550F (15.24 m; 50 ft)	25.40 cm (10 in)
	H561 (18.59 m; 61 ft)	19.05, 25.40, 31.75 cm (7.5, 10, 12.5 in)	H560F (18.29 m; 60 ft)	25.40 cm (10 in)



AIR CARTS	C350L	C400L	C500L	C550L	C650L*
	Leading	Leading	Leading	Leading	Leading
CART CAPACITY					
Total (L)	12,333 L	14,095 L	17,619 L	19,381 L	22,905 L
Number of Tanks	2	3	3	4	4
Tank Splits (L)	5,638/6,695 L	1,761/5,638/6,695 L	6,695/3,171/7,752 L	1,761/6,695/3,171/7,752 L	1,761/9,162/4,581/7,400 L
CONVEYANCE					
Conveyor Capacity (Wheat)	2,325 L/min	2,325 L/min	2,325 L/min	2,325 L/min	3523 L/min
Auger Capacity (Wheat)	1,726 L/min	1,726 L/min	1,726 L/min	1,726 L/min	N/A
AIR SYSTEM					
Blower Options	Standard Capacity	Standard Capacity	Standard Capacity or High Capacity	Standard Capacity or High Capacity	Standard Capacity or High Capacity
Number of Blowers	Single or Dual	Single or Dual	Single or Dual	Single or Dual	Single or Dual
Product Delivery Hoses	2.5 in. (6.4 cm)	2.5 in. (6.4 cm)	2.5 in. or 3 in. (6.4 cm or 7.6 cm)	2.5 in. or 3 in. (6.4 cm or 7.6 cm)	2.5 in. or 3 in. (6.4 cm or 7.6 cm)
METERING					
Meter Housing Material	Stainless Steel	Stainless Steel	Stainless Steel	Stainless Steel	Stainless Steel
DIMENSIONS					
Height (Transport)	13 ft 2 in. (4.00 m)	13 ft 2 in. (4.00 m)	13 ft 2 in. (4.00 m)	13 ft 2 in. (4.00 m)	13 ft 4 in. (4.05 m)
Height (Field)	13 ft 9 in. (4.20 m)	13 ft 9 in. (4.20 m)	13 ft 9 in. (4.20 m)	13 ft 9 in. (4.20 m)	16 ft 3 in. (4.94 m)
Length Overall	31 ft 1 in. (9.47 m)	31 ft 1 in. (9.47 m)	31 ft 9 in. (9.68 m)	31 ft 9 in. (9.68 m)	39 ft 5 in. (12.0 m)
Width with Base Equipment Tyres	13 ft 9 in. (4.2 m)	13 ft 9 in. (4.2 m)	17 ft 6 in. (5.34 m)	17 ft 6 in. (5.34 m)	20 ft 2 in. (6.16 m)
Width with High Floatation Tyres	17 ft 6 in. (5.34 m)	17 ft 6 in. (5.34 m)	18 ft 10 in. (5.75 m)	18 ft 10 in. (5.75 m)	21 ft 8 in. (6.62 m)
Shipping Weight - Base Equipment	13530 lb (6137 kg)	14692 lb (6664 kg)	19806 lb (8984 kg)	21320 lb (9671 kg)	29671 lb (14250 kg)
Shipping Weight - High Floatation Option	16308 lb (7397 kg)	17469 lb (7924 kg)	21516 lb (9760 kg)	23031 lb (10447 kg)	31176 lb (14932 kg)
FRONT TYRES					
Base Equipment	N/A	N/A	N/A	N/A	N/A
High Floatation Option	N/A	N/A	N/A	N/A	N/A
REAR TYRES					
Base Equipment	710/70R-38R1W (Singles)	710/70R-38R1W (Singles)	650/85R38 173B R-1W FS (Duals)	650/85R38 173B R-1W FS (Duals)	800/70R38 SFT (Duals)
High Floatation Option	650/85R38 173B R-1W FS (Duals)	650/85R38 173B R-1W FS (Duals)	800/70R38 (Duals)	800/70R38 (Duals)	IF850/75R42 CFO/CHO (Duals)

AIR CARTS	C350T	C400T	C500T	C550T	C650T*	C850T*
	Trailing	Trailing	Trailing	Trailing	Trailing	Trailing
CART CAPACITY						
Total (L)	12,333 L	14,095 L	17,619 L	19,381 L	22,905 L	29,953 L
Number of Tanks	2	3	3	4	4	4
Tank Splits (L)	5,638/6,695 L	1,761/5,638/6,695 L	6,695/3,171/7,752 L	1,761/6,695/3,171/7,752 L	1,761/9,162/4,581/7,400 L	1,761/9,162/4,581/14,448 L
CONVEYANCE						
Conveyor Capacity (Wheat)	2,325 L/min	2,325 L/min	2,325 L/min	2,325 L/min	3523 L/min	3523 L/min
Auger Capacity (Wheat)	1,726 L/min	1,726 L/min	1,726 L/min	1,726 L/min	N/A	N/A
AIR SYSTEM						
Blower Options	Standard Capacity	Standard Capacity	Standard Capacity or High Capacity	Standard Capacity or High Capacity	Standard Capacity or High Capacity	High Capacity
Number of Blowers	Single or Dual	Single or Dual	Single or Dual	Single or Dual	Single or Dual	Single or Dual
Product Delivery Hoses	2.5 in.	2.5 in.	2.5 in. or 3 in. (6.4 cm or 7.6 cm)	2.5 in. or 3 in. (6.4 cm or 7.6 cm)	2.5 in. or 3 in. (6.4 cm or 7.6 cm)	3 in. (7.6 cm)
METERING						
Meter Housing Material	Stainless Steel	Stainless Steel	Stainless Steel	Stainless Steel	Stainless Steel	Stainless Steel
DIMENSIONS						
Height (Transport)	13 ft 2 in (4.00 m)	13 ft 2 in (4.00 m)	13 ft 2 in. (4.00 m)	13 ft 2 in. (4.00 m)	13 ft 4 in. (4.05 m)	13 ft 4 in. (4.05 m)
Height (Field)	13 ft 9 in (4.20 m)	13 ft 9 in (4.20 m)	13 ft 9 in. (4.20 m)	13 ft 9 in. (4.20 m)	16 ft 3 in. (4.94 m)	16 ft 3 in. (4.94 m)
Length Overall	27 ft 1 in (8.27 m)	27 ft 1 in (8.27 m)	28 ft 7 in. (8.72 m)	28 ft 7 in. (8.72 m)	38 ft 11 in. (11.86 m)	44 ft 7 in. (13.582 m)
Width with Base Equipment Tyres	13 ft 9 in (4.2 m)	13 ft 9 in (4.2 m)	17 ft 6 in. (5.34 m)	17 ft 6 in. (5.34 m)	17 ft 8 in (5.38 m)	20 ft 2 in. (6.16 m)
Width with High Floatation Tyres	17 ft 6 in (5.34 m)	17 ft 6 in (5.34 m)	18 ft 10 in. (5.75 m)	18 ft 10 in. (5.75 m)	20 ft 2 in. (6.16 m)	21 ft 8 in. (6.62 m)
Shipping Weight - Base Equipment	16305 lb (7396 kg)	17467 lb (7923 kg)	22661 lb (10279 kg)	24178 lb (10967 kg)	32761 lb (15650 kg)	35468 lb (16088 kg)
Shipping Weight - High Floatation Option	19987 lb (9066 kg)	21149 lb (9593 kg)	25276 lb (11465 kg)	26793 lb (12115 kg)	34839 lb (16594 kg)	37340 lb (16937 kg)
FRONT TYRES						
Base Equipment	21.5L-16.1 I-3T 8PR (Duals)	21.5L-16.1 I-3T 8PR (Duals)	21.5L-16.1 I-3T 8PR (Duals)	21.5L-16.1 I-3T 8PR (Duals)	IF800/70R38 CFO/CHO tyres	800/70R38 SFT tyres
High Floatation Option	710/70R-38R1W (Singles)	710/70R-38R1W (Singles)	650/50R22.5 885 I-3 163D (Duals)	650/50R22.5 885 I-3 163D (Duals)	IF900/75R32 CFO/CHO tyres	IF900/75R32 CFO/CHO tyres
REAR TYRES						
Base Equipment	650/85R38 173B R-1W FS (Duals)	650/50R22.5 885 I-3 163D (Duals)	650/85R38 173B R-1W FS (Duals)	650/85R38 173B R-1W FS (Duals)	650/85R38 (Duals)	800/70R38 SFT (Duals)

\*Not available in New Zealand





## Supported by one of the most responsive dealer networks in the business

Nobody cares more about keeping your equipment in solid working order than your John Deere dealer. With a complete inventory of genuine John Deere parts, highly trained service technicians, and a thorough understanding of your business, your John Deere dealer knows how to keep you and your equipment up and running.

A strong name in equipment, and a strong dealership network: get it all with John Deere.



**JOHN DEERE**

This literature has been compiled for worldwide circulation. While general information, pictures and descriptions are provided, some illustrations and text may include finance, credit, insurance, product options and accessories NOT AVAILABLE in all countries or regions. In some countries, products and accessories may require modifications or additions to ensure compliance with the local regulations of those countries. PLEASE CONTACT YOUR LOCAL DEALER FOR DETAILS. John Deere reserves the right to change specification and design of all products described in this literature without notice. John Deere's green and yellow colour scheme, the leaping deer symbol, and JOHN DEERE are trademarks of Deere & Company. All photography and illustrations contained herein are copyrighted assets of Deere & Company.

**JohnDeere.com.au**  
**JohnDeere.co.nz**